

Miniature Quick Wire Connector Thermocouple Plug FMTC-CU-MQ Type Cu

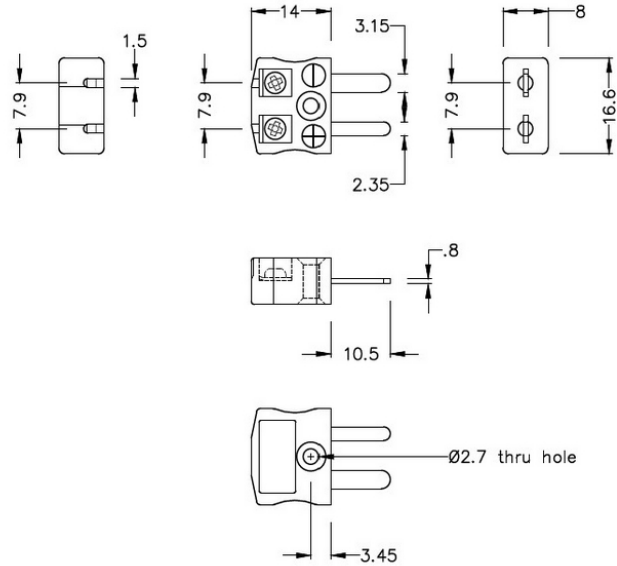

Miniature in-line Plug - Quick Wire
(dimensions in mm)

General Description	Easy jab-in connection for rapid termination.
Thermocouple Type	IEC, ANSI, JIS Type CU
Connector Type	Quick Wire Plug
Connector Size	Miniature
Colour	White
Max. Temperature	220°C
Pins	Flat Pins
+Positive Contact	Copper
-Negative Contact	Copper
Standards Met	BS EN 50212:1997. RoHS