

## Standard Thermocouple Connector Duplex Socket JS-K-FD Type K JIS

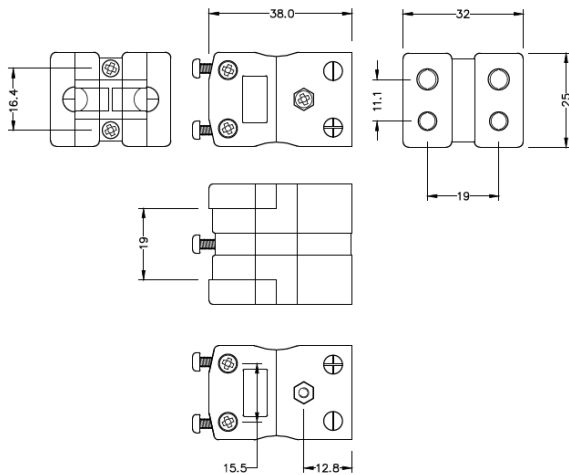

**Standard Duplex in-line Socket**  
(dimensions in mm)

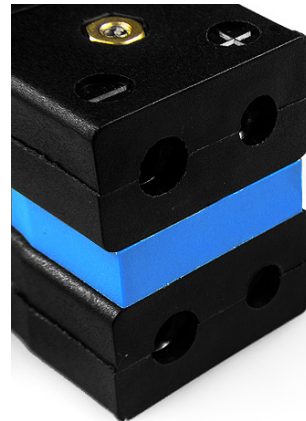

Labfacility are the UK's leading manufacturer of Temperature Sensors, Thermocouple Connectors and associated Temperature Instrumentation and stockings of Thermocouple Cables. The Company has been trading since 1971 and is ISO9001 accredited.

**Standard Thermocouple Connector Duplex Socket JS-K-FD Type K JIS**

Rugged glass filled polyester bodies. Contacts are polarised to prevent incorrect connection

**Specifications****Specifications**

<b>Product Code</b>	XE-9287-001
<b>General Description</b>	Plugs fitted with solid thermocouple pins. Rugged glass filled polyester bodies, suitable for industrial applications.
<b>Thermocouple Type</b>	K JIS
<b>Connector Type</b>	Duplex Socket
<b>Connector Size</b>	Standard
<b>Colour</b>	Blue
<b>Dimensions</b>	See Schematic Drawing (Product Literature Tab)
<b>Max. Temperature</b>	220°C
<b>+Positive Contact</b>	Nickel Chromium
<b>-Negative Contact</b>	Nickel Alloy
<b>Standards Met</b>	BS EN 50212:1997. RoHS