

Standard Thermocouple Connector Duplex Socket JS-J-FD Type J JIS

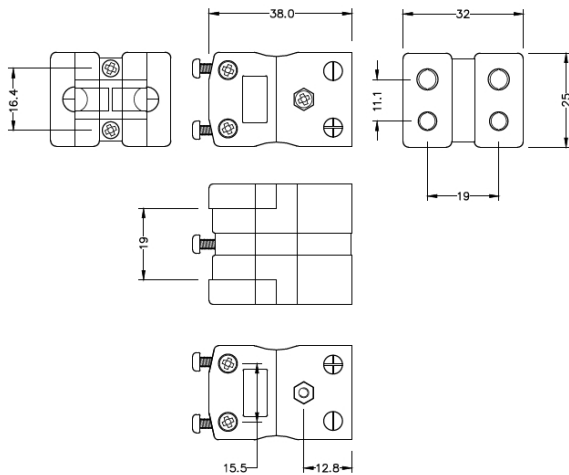

Standard Duplex in-line Socket
(dimensions in mm)

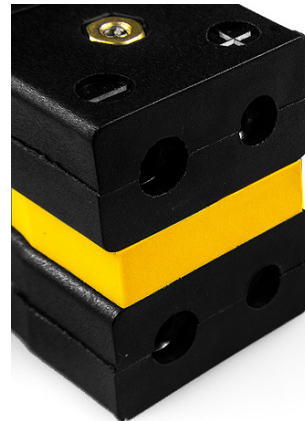

Labfacility are the UK's leading manufacturer of Temperature Sensors, Thermocouple Connectors and associated Temperature Instrumentation and stockings of Thermocouple Cables. The Company has been trading since 1971 and is ISO9001 accredited.

Standard Thermocouple Connector Duplex Socket JS-J-FD Type J JIS

Rugged glass filled polyester bodies. Contacts are polarised to prevent incorrect connection

Specifications**Specifications**

Product Code	XE-9307-001
General Description	Plugs fitted with solid thermocouple pins. Rugged glass filled polyester bodies, suitable for industrial applications.
Thermocouple Type	J JIS
Connector Type	Duplex Socket
Connector Size	Standard
Colour	Yellow
Dimensions	See Schematic Drawing (Product Literature Tab)
Max. Temperature	220°C
+Positive Contact	Iron
-Negative Contact	Copper Nickel
Standards Met	BS EN 50212:1997. RoHS